



SFILIGOI



Made in Italy



**UNYX  
PROGRESS  
SQUARE**



IN THE LIGHT OF EXPERTISE

The strongest  
advanced  
lighting solution



# CUTTING EDGE TECHNOLOGICAL SMART CONNECTION

The optimal solution for  
any type of crane



**PROFESSIONAL LIGHTING SYSTEMS  
FOR PORT AREA**

Some **application areas:**



**QUAY CRANE**  
STS, QC

**Sfiligoi products:**

UNYX series  
PROGRESS series  
SQUARE series



**YARD CRANE**  
RTG, RMG

**Sfiligoi products:**

UNYX series  
PROGRESS series

## Research, experience and passion at the service of any project

We always provide answers aimed at satisfying the specific needs of our customers. We guarantee high quality standards during installation, ensuring a complete assistance service at every stage of the work, from design to commissioning. We comply with lighting restrictions and regulatory constraints relating to glare.



## THE LIGHTING SOLUTION WITH INTEGRATED "HEALTH STATUS" SYSTEM



Operational control  
and monitoring system



It allows to simplify  
maintenance activities



Programmed switching on and off of the  
floodlight(s) according to operational or ambient needs



Real time  
energy control



## Preventive maintenance

intervening when needed in a targeted and organised way,  
without wasting time and resources.

Maximum versatility, for each single floodlight or groups.

# UNYX

The exclusive advanced Sfiligoi lighting system

## ✓ Suitable for

### Container cranes (STS / QC)

**model:**

- SMALL
- SMALL SPLIT
- MEDIUM HOR
- MEDIUM VER
- LARGE VER
- LARGE HOR
- EAL+SWL FRONT
- EAL+SWL BACK
- EAL

**application:**

Portal beam, machinery house, electrical room  
Portal beam  
Main beam  
Main beam  
Main beam  
Main beam  
Trolley  
Trolley  
Trolley

### Yard container cranes (RTG / RMG)

**model:**

- X-SMALL
- SMALL

**application:**

Girder, sill beam  
Girder, trolley



## Suitable also for existing structures

Professional design which guarantees an installation without major electrical and mechanical modifications.

## Fast replacement and no major actions

## Integrated software

To guarantee a better visibility and to increase operator' safety and productivity.

## Anti-Glare System

Innovative system which allows to decrease automatically the reflected light detected, due to rainy days or reefer containers, when the light is over a certain given value, reducing glare to the operator.



Version EAL + SWL

## Electronic Adaptive Light®

### (EAL System)

Adaptive smart lighting system, which varies the intensity and amplitude of the light beam according to the height of the spreader.

## Safety Working Light

### (SWL System-Front)

To ensure greater illumination on the ground of at least 20 meters in front of the operator, when the trolley goes forward, from the quay to the ship.

## Safety Working Light

### (SWL System-Back)

Orange blinking light to warn operators that the trolley is going back, from the ship to the quay. Safety enhanced.



8

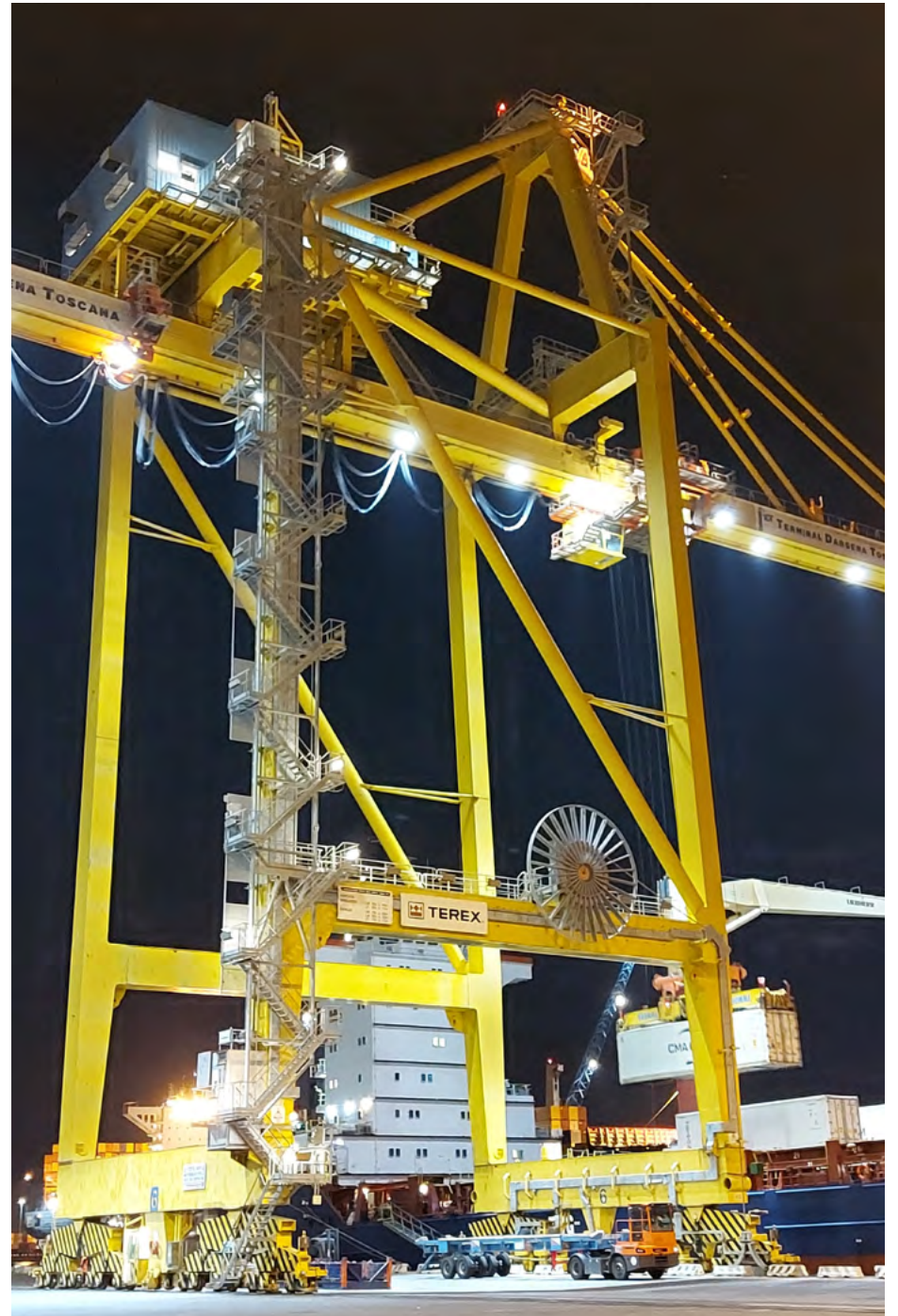

9

# PROGRESS

The exclusive advanced Sfiligoi lighting system

✓ Suitable for

## Container cranes (STS / QC)

- |                    |                     |
|--------------------|---------------------|
| <b>model:</b>      | <b>application:</b> |
| - 12 W MIX AC/DC   | Walkways/Stairs     |
| - 12 W 230 V AC    | Walkways/Stairs     |
| - EM 12 W 230 V AC | Walkways/Stairs     |
| - 12 W 24V DC      | Walkways/Stairs     |

## Yard container cranes (RTG / RMG)

- |                    |                     |
|--------------------|---------------------|
| <b>model:</b>      | <b>application:</b> |
| - 12 W MIX AC/DC   | Walkways/Stairs     |
| - 12 W 230 V AC    | Walkways/Stairs     |
| - EM 12 W 230 V AC | Walkways/Stairs     |
| - 12 W 24V DC      | Walkways/Stairs     |



A fixture studied in order **not to glare**

and to guarantee the access in total safety.

## Half quantity of luminaires

Thanks to the light beam of this lamp, it is possible to halve, compared to standard solutions, the quantity of luminaires to be installed, satisfying the safety requirements.

### Example:

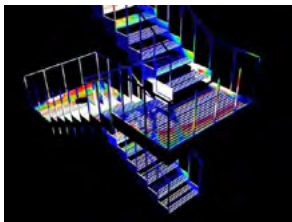

Lighting calculation (stairway)



(Picture of a Progress light installed)

# SQUARE

The exclusive advanced Sfiligoi lighting system

✓ Suitable for

## Container cranes (STS / QC)

- |               |                                       |
|---------------|---------------------------------------|
| <b>model:</b> | <b>application:</b>                   |
| - Square      | Main beam with recessed lights inside |

System which can operate at high temperatures **+70°C**

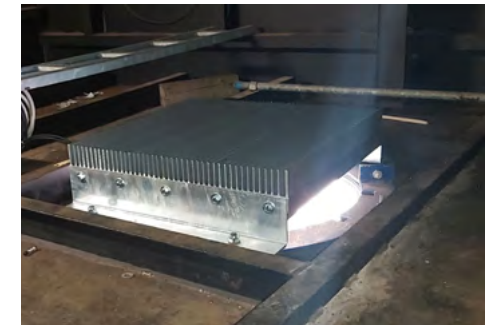

(Picture of a Square floodlight installed)



**Our range  
of products - UNYX**



**UNYX - X SMALL**



**UNYX - SMALL**



**UNYX - LARGE HOR**



**UNYX - EAL**



**UNYX - SMALL SPLIT**



**UNYX - MEDIUM HOR**



**UNYX - EAL+SWL FRONT**



**UNYX - EAL+SWL BACK**



**UNYX - MEDIUM VER**



**UNYX - LARGE VER**

**Our range  
of products - PROGRESS**



**PROGRESS - 12W  
24V DC**



**PROGRESS - 12W  
MIX AC/DC**



**PROGRESS - 12W  
230V AC**



**PROGRESS - EM 12W  
230V AC**

**Our range  
of products - SQUARE**



**SQUARE**

IN THE LIGHT OF EXPERTISE



**SFILIGOI**

Via Alessandro Magio 21,  
36061 Bassano Del Grappa (VI) - Italia  
tel. +39 0424 383375  
[www.sfiligoi.it](http://www.sfiligoi.it)